

get your own **GREEN PARADISE**

RERA REGISTRATION NO.
UPRERAPRJ3075



Artistic Impression

about

RIDGE RESIDENCY

Homes are our life, and Ridge Residency by Today Homes have been designed in a perfect synchronisation with nature.

Ridge Residency is an immaculately planned development in sector-135, abetting Noida Expressway. Just 10 mins drive from Delhi, Ridge Residency is one the most exclusive address in Noida.

Sprawling over 13 acres, Ridge residency is an amalgamation of the very best of modern urban planning, heralding the dawn of a new architectural era. The building form comprises of perfect harmony between tower and greens and has been laid around network of well laid wide roads making it secure from the outside world.

The high-rise lifestyle choice will offer a variety of two, three and four bedroom apartments in distinct building styles. Apartments will be dispersed around open landscaped courtyards allowing for utmost privacy, whilst enjoying views onto the walkways.

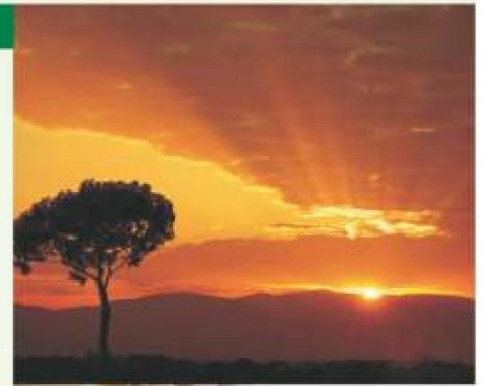

RIDGE
RESIDENCY

DREAM HOMES ABETTING NOIDA EXPRESSWAY



Some of the main highlights of Ridge Residency are:

- Approx 13 Acres*
- Located in habitated sec-135, Noida abetting expressway.
- Proposed access to site from kalindi kunj.
- Located in low density sector.
- Proposed metro connectivity in the close vicinity.
- Near to operational TCS, Accenture & Metlife offices.
- Best schools & hospital in the vicinity.
- Club House with swimming pool.
- Secured Gated Community.
- Power Back-up.

*Condition apply

Floor Plans

3 Bedroom unit with store room

Super Area = 139.353 Sq.Mts. (1500.00 Sq.ft.)
 RERA Carpet Area = 80.414 Sq.Mts. (865.576 Sq.ft.)
 Balcony Area = 6.209 Sq.Mts. (66.834 Sq.ft.)
 External Wall Area = 6.732 Sq.Mts. (72.463 Sq.ft.)

Block-F



3 BED + STORE + 2 TOILET



3 Bed + Servant + 3 Toilet

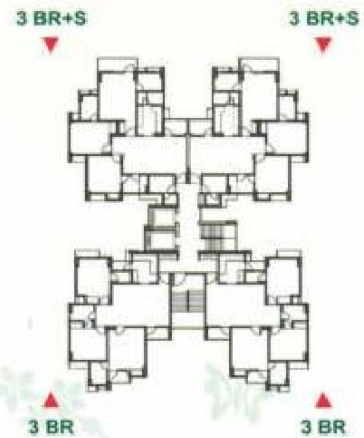

Block-G,H&Q
Typical Floor

3 Bedroom unit with servant room

Super Area = 159.792 Sq.Mts. (1720.00 Sq.ft.)
 RERA Carpet Area = 89.260 Sq.Mts. (960.795 Sq.ft.)
 Balcony Area = 10.963 Sq.Mts. (118.006 Sq.ft.)
 External Wall Area = 7.381 Sq.Mts. (79.449 Sq.ft.)

Floor Plans

2 Bedroom unit

Super Area = 99.870 Sq.Mts. (1075.00 Sq.ft)
 RERA Carpet Area = 58.682 Sq/Mts. (631.653 Sq.ft.)
 Balcony Area = 3.186 Sq.Mts. (34.294 Sq.ft.)
 External Wall Area = 5.272 Sq.Mts. (56.747 Sq.ft.)



Block-I, J, L, M, P & A



RIDGE
 RESIDENCY
 Sector 135, Noida Expressway

2 Bedroom unit with study room

Super Area = 113.805 Sq.Mts. (1225.00 Sq.ft)
 RERA Carpet Area = 66.375 Sq/Mts. (714.461 Sq.ft.)
 Balcony Area = 5.204 Sq.Mts. (56.016 Sq.ft.)
 External Wall Area = 5.596 Sq.Mts. (60.235 Sq.ft.)



Specifications

LIVING DINING

Floor – Vitrified

Walls / Ceiling – Oil Bound Distemper

STAIRCASE

Kota Stone with M.S Grill

BEDROOM'S

Floor – Vitrified

Walls / Ceiling – Oil Bound Distemper

SERVANT ROOM

Floor – Ceramic Tiles

Walls / Ceiling – Oil Bound Distemper

DOOR / WINDOWS

External door / window frame in metal with Glass Door

Internal Door/ window frame in Hardwood Frame, with flush door.

BALCONIES

Floor – Anti skid Tiles

TOILET'S

Floor – Anti skid Tiles

Dado – Ceramic Tiles upto 7ft height.

Vanity – Granite Counter with mirror only in Master Bedroom Toilet.

Standard fixtures and fittings.

ELECTRICALS

All copper electrical wiring in concealed conduits, Provision for adequate Light & Power Point, Living room, moulded plastic switches with protective MCB's

AC/ Telephone & TV outlets in all bedrooms

KITCHEN

Floor - Anti skid Tiles

Dado – Ceramic Tiles upto 2ft height above counter

Walls / Ceiling - Oil Bound Distemper

Counter-Granite Slab,

Stainless steel sink



Location Map

(NOT TO SCALE)

Today
HOMES
Solutions for tomorrow. Today

Marketing Office:

B-21, First Floor, Sector-2, Noida •

Email: noidasales@todayhomes.co.in • Web: www.todayhomes.co.in

"All Contents with respect to the Project details is subject to The Real Estate (Regulation and Development) Act 2016 and rules framed there under implementation, thereof. The informations / specifications contained herewith is indicative only and subject to change. Developer reserves the right to amend the layout plans, specifications amenities and area as per prevailing Governments norms."