



**WATER WALLS LINING THE STUNNING TERRACED POOL**



BE INSPIRED WITH WATER WALL THAT EXTENDS TO VERTICAL GARDENS & TREE BOSQUES WITH A SPACIOUS DECK AREA



UNIQUELY DESIGNED BEST-IN-CLASS  
FLOATING RESTAURANT



UNWIND IN STYLE WITH  
POOLSIDE CABANAS



**WATER CHANNELS WITH SHALLOW BROOKS  
AND PEDESTRIAN WALKWAYS**



UNWIND AND TREAT YOUR SENSES  
AT THE LUXURY SPA\*



BESPOKE LANDSCAPE

## CLUB AMENITIES



STATE-OF-THE-ART GYM WITH A SPECTACULAR VIEW

Stock image for representative purpose only.

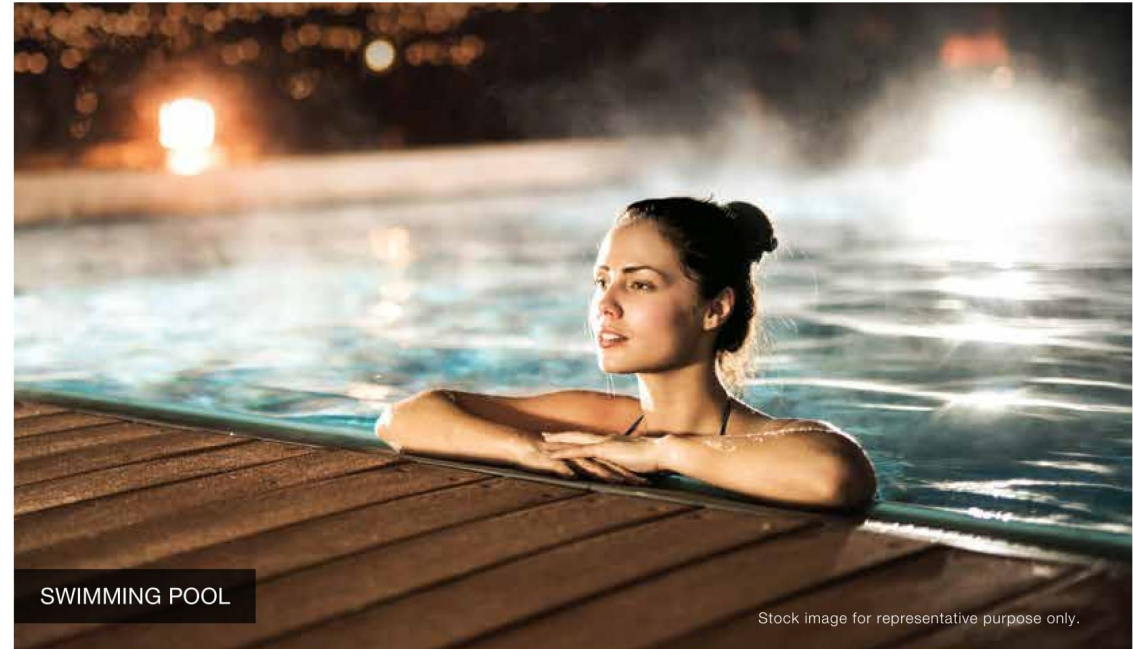

SWIMMING POOL

Stock image for representative purpose only.



Stock image for representative purpose only.

EXQUISITE MOVIE EXPERIENCE AT THE MINI-THEATRE



Stock image for representative purpose only.

TENNIS COURT



Stock image for representative purpose only.

BADMINTON COURT





SQUASH COURT

Stock image for representative purpose only.

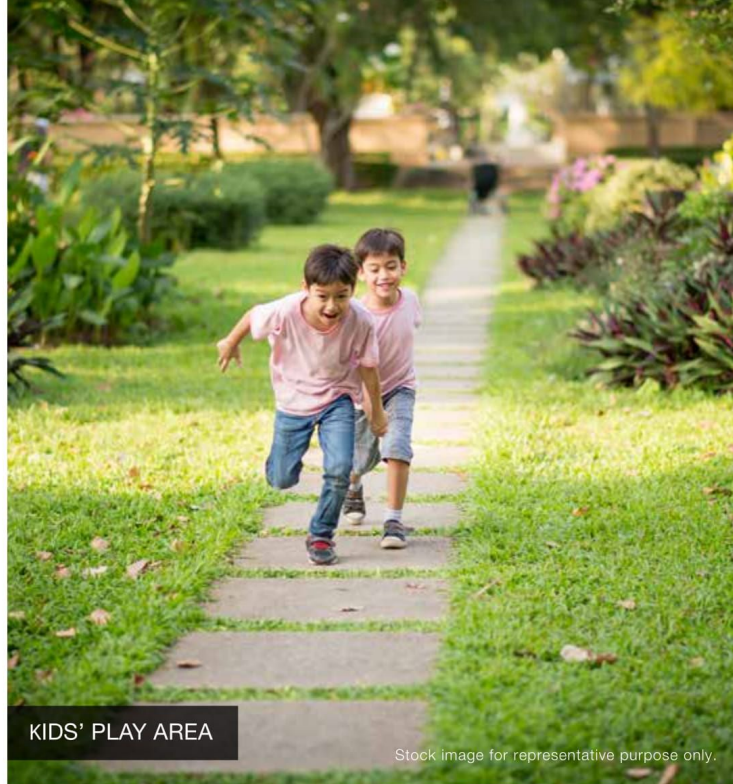

KIDS' PLAY AREA

Stock image for representative purpose only.



LIBRARY

Stock image for representative purpose only.



INDOOR GAMES ARENA

Stock image for representative purpose only.



CARDS ROOM

Stock image for representative purpose only.

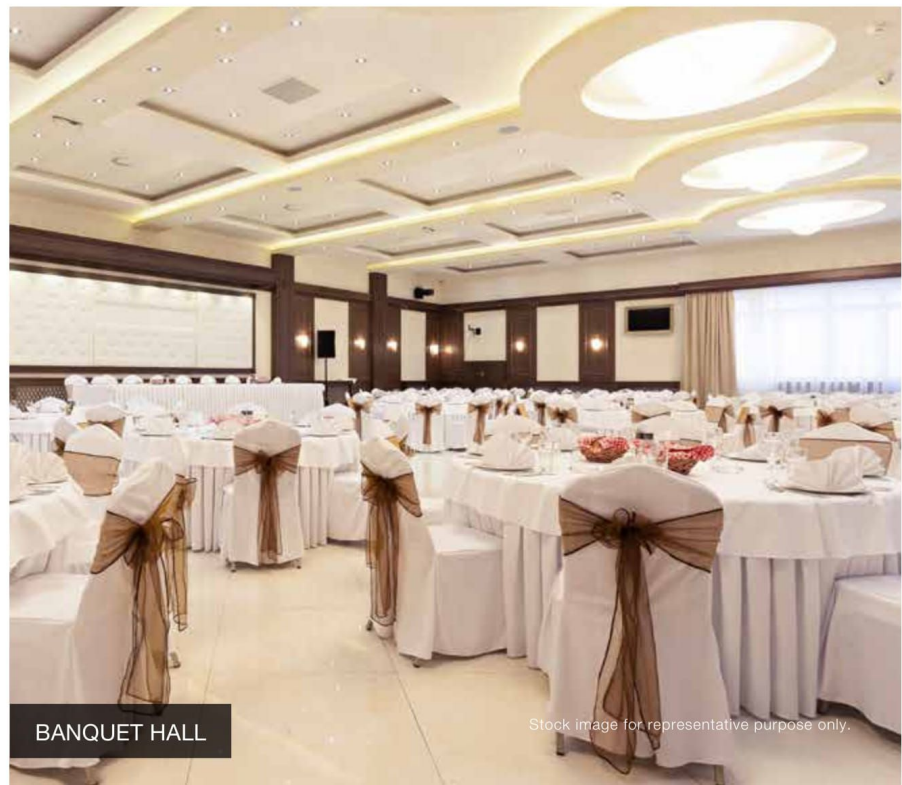

BANQUET HALL

Stock image for representative purpose only.



## KOI-LILY POND

Stock image for representative purpose only.



JOGGING TRACK

Stock image for representative purpose only.



BRANDED RETAIL

Stock image for representative purpose only.



AMPHITHEATRE

Stock image for representative purpose only.



SCULPTURED KIDS' PLAY AREA

Stock image for representative purpose only.

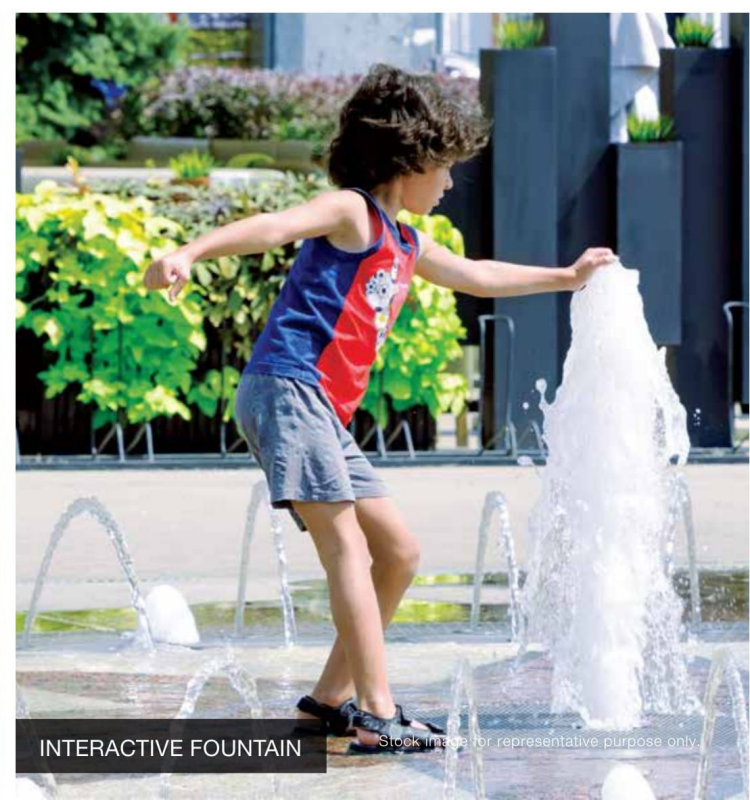

INTERACTIVE FOUNTAIN

Stock image for representative purpose only.

# TERRACE GARDEN AMENITIES



EXERCISE STATION

Stock image for representative purpose only.



MEDITATION ZONE

Stock image for representative purpose only.



HOPSCOTCH

Stock image for representative purpose only.



FOUNTAINS

Stock image for representative purpose only.



HIBISCUS GARDEN

Stock image for representative purpose only.



PERGOLAS

Stock image for representative purpose only.



# GREEN HAVEN

REJUVENATE YOUR SENSES  
AMIDST LUSH GREEN ENVIRONS



EXPERIENCE THE ABUNDANCE OF  
20,000 SQUARE METER OF CENTRAL GREENS



SEASONAL PLANTING PALETTE FOR AN ENHANCED ENTRANCE LANDSCAPE

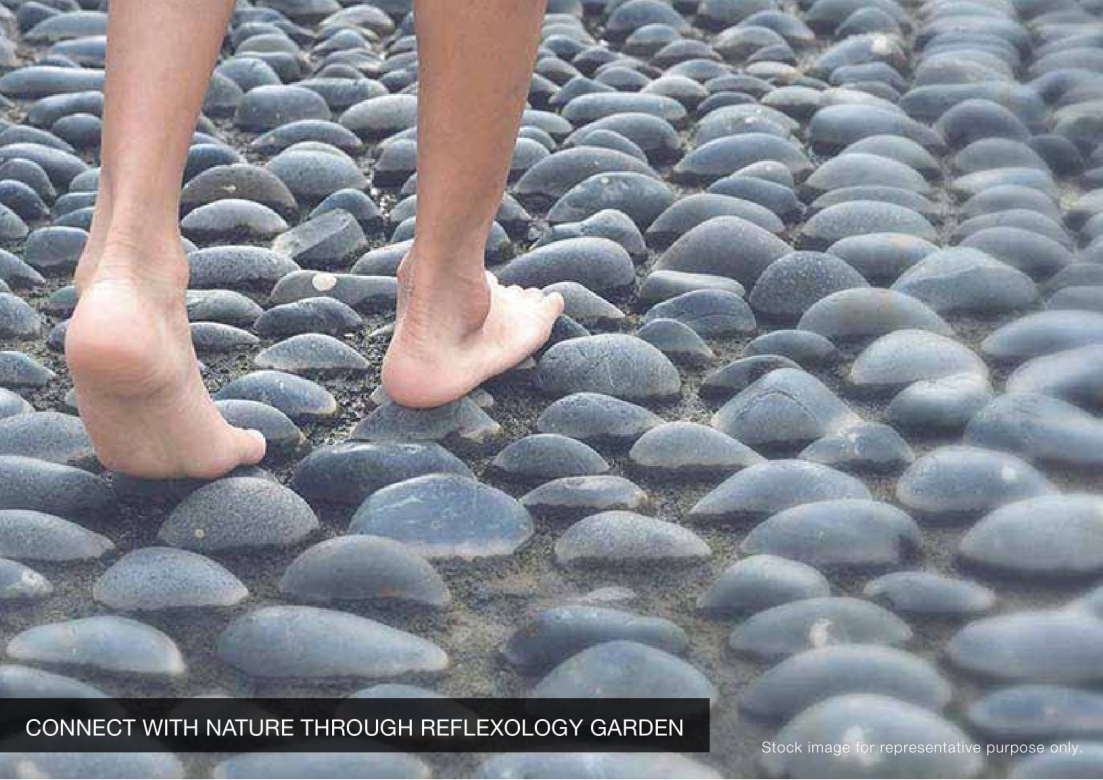

CONNECT WITH NATURE THROUGH REFLEXOLOGY GARDEN

Stock image for representative purpose only.



UNMATCHED EXPERIENCE OF BOTANICAL PATHWAY

Stock image for representative purpose only.

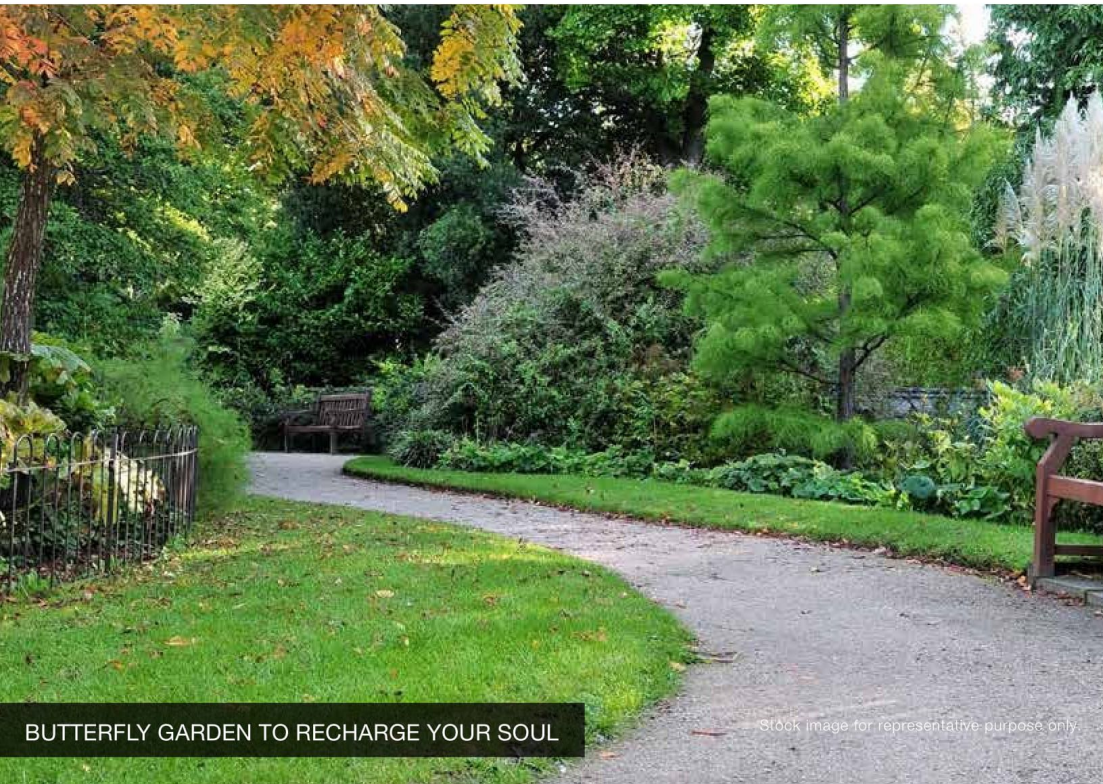

BUTTERFLY GARDEN TO RECHARGE YOUR SOUL

Stock image for representative purpose only.



SPECTACULAR COLOUR AND MAZE GARDEN

Stock image for representative purpose only.



EXQUISITE PLANTATIONS



Stock image for representative purpose only.



WEeping FIG

Stock image for representative purpose only.



SHELL GINGER

Stock image for representative purpose only.

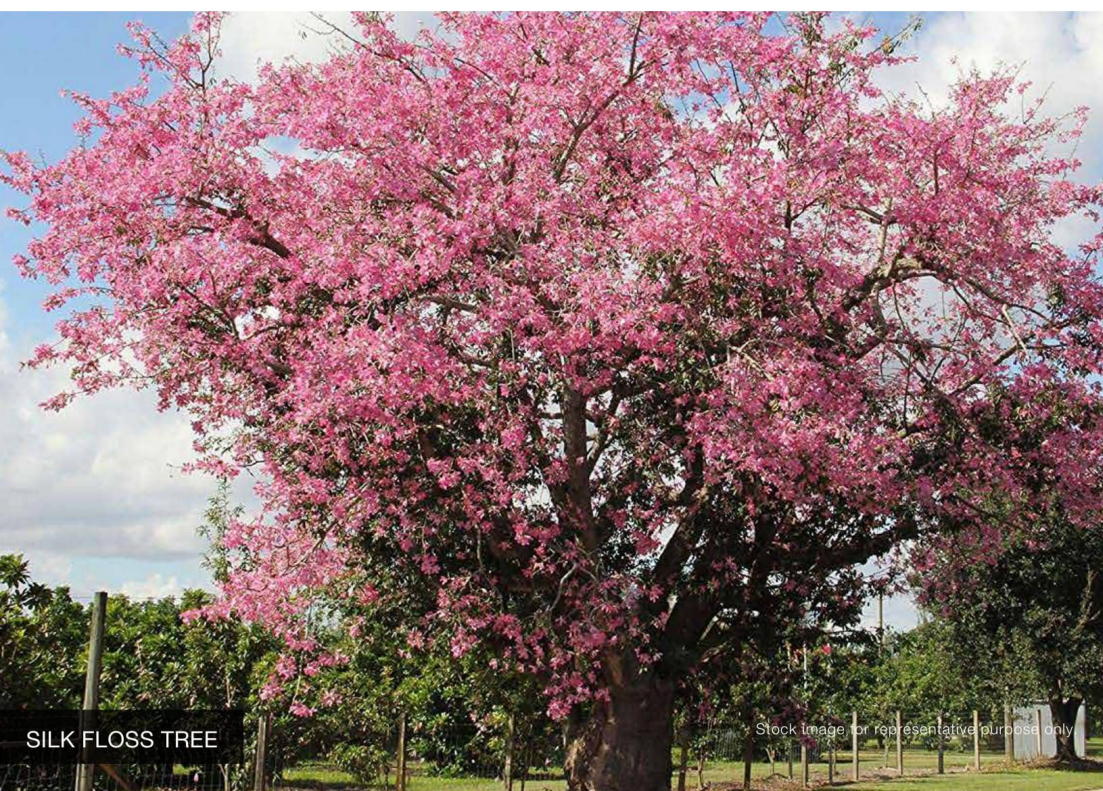

SILK FLOSS TREE

Stock image for representative purpose only.



MILKWOOD PINE

Stock image for representative purpose only.



PLUMERIA

Stock image for representative purpose only.



CHAMPA

Stock image for representative purpose only.



NIGHT JASMINE

Stock image for representative purpose only.



CAPE JASMINE

Stock image for representative purpose only.



ORANGE JASMINE

Stock image for representative purpose only.



THAI GRAPE

Stock image for representative purpose only.



PINK TABEBUIA

Stock image for representative purpose only.



# CONSCIOUSLY CRAFTED

TO PROVIDE AN EXOTIC  
EXPERIENCE AT EVERY STEP



23 MARINA DUBAI  
DESIGN ARCHITECTURE BY HAFEEZ CONTRACTOR

Stock image for representative purpose only.

One of the designed projects of Hafeez Contractor. Does not in any form represent Godrej Palm Retreat.



EXQUISITELY DESIGNED FEATURES  
TO GREET YOU AT EVERY STEP



## LOW-RISE DEVELOPMENT\*

Artist's impression. Not an actual site photograph.

\*Except iconic towers



## DOUBLE HEIGHTED LOBBY





ICONIC LANDMARK AS YOUR HOME

Artist's impression. Not an actual site photograph.



LOW-DENSITY LIVING



GLASS RAILINGS IN BALCONIES



HOMES DESIGNED FOR EXCELLENT NATURAL DAY LIGHT



COME HOME TO AN AMBIENCE WITH  
WELL-VENTILATED LIVING ROOMS



## SPACIOUS BEDROOMS

## INVENTORY DETAILS

Typology	Carpet Area (In Square Meter)	Exclusive Area (In Square Meter)	Total Area (In Square Meter)
2 BHK	71.62	11.47	83.09
2 BHK	71.84	11.58	83.42
2 BHK	74.37	11.73	86.1
2 BHK	90.81	12.7	103.51
2 BHK	90.81	16.83	107.64
3 BHK	111.68	16.83	128.51
3 BHK	135.17	26.58	161.75
4 BHK	176.75	36.26	213.01
4 BHK	176.75	83.8	260.55

## PRIORITY GENERATION PROCESS

₹1 Lakh online payment / DD / Card swipe & ₹4 Lakh current dated cheque

Submission of application form

KYC documents

Premier Allotment option available.  
Please contact your Relationship Manager within Godrej Properties to upgrade.

## PAY MORE, SAVE MORE

**Pay ₹5 Lakh and Save ₹1 Lakh on the Property Cost**

## RTGS DETAILS

<b>Account Title</b>	<b>Godrej ACE 150 Phase 1</b>
Account Number	777705800081
Bank Name	ICICI Bank
IFSC Code	ICIC0006615
Branch Name	Udyog Vihar, Sector 18, Udyog Vihar, Gurgaon
Branch Address	ICICI Bank Ltd, SCO 31, Sector 18, Udyog Vihar, Gurgaon



JOINT VENTURE PARTNER



**RERA REGISTRATION: Godrej Palm Retreat 1 - UPRERAPRJ745601, Godrej Palm Retreat 2 – UPRERAPRJ124632 - [www.up-rera.in](http://www.up-rera.in). NOIDA/M.V.N/2019/IV-1485/1121 dated 15.05.2019**

This contains artistic impressions and no warranty is expressly or impliedly given that the completed development will comply in any degree with such artist's impression as depicted. The furniture, accessories, paintings, items, electronic goods, fittings/fixtures, decorative, false ceiling including finishing materials, specifications, shades, sizes, etc shown in the pictures are only indicative in nature and for illustrative purpose only & does not form a part of the standard specification. Project is being developed by ACE Infracity Developers Pvt. Ltd. ("Developer") and has appointed Godrej Projects Development Limited as the Development Manager for the same. Recipients are advised to apprise themselves of the necessary and relevant information of the project/offer prior to making any purchase decisions. The sale is subject to terms of application form and agreement for sale/sub-lease. All specifications of the unit shall be as per the final agreement between the Parties. Recipients are advised to apprise themselves of the necessary and relevant information of the project prior to making any purchase decisions. Govt charges/lease rent/applicable taxes extra. The details shown in the image are only indicative in nature and are only for the purpose of illustrating/indicating a possible layout and do not form part of the standard specifications/amenities/services to be provided in the flat.

The background features a repeating pattern of stylized palm fronds in various shades of blue, ranging from light to dark, set against a light blue gradient background. The fronds are arranged in a way that creates a sense of depth and movement.

# **GODREJ PALM RETREAT**

SECTOR 150, NOIDA



BRAND GODREJ

Godrej Properties brings the Godrej Group philosophy of innovation, sustainability, and excellence to the real estate industry. Each Godrej Properties development combines a 122-year legacy of excellence and trust with a commitment to cutting-edge design and technology.

IN RECENT YEARS, GODREJ PROPERTIES  
HAS RECEIVED OVER 200 AWARDS & RECOGNITIONS





INTRODUCING GODREJ PROPERTIES'  
FIRST-EVER RESORT RESIDENCES



HOME IN THE  
GREENEST SECTOR  
OF NOIDA\*



EXOTIC RESORT  
LIVING



GREEN  
HAVEN



CONSCIOUSLY  
CRAFTED





# HOME IN THE GREENEST SECTOR\* IN NOIDA

WITH CONVENIENCES AND  
COMFORTS THAT ARE CLOSER TO YOU



WELCOME TO THE GREENEST SECTOR OF NOIDA\*  
WHERE LIVING IS AN EVERYDAY JOY

# LOCATION MAP

## LEGENDS



**GODREJ PALM RETREAT**  
SECTOR 150, NOIDA

-  LANDMARK
-  COMMERCIAL
-  AIRPORT
-  MALL
-  HOSPITAL
-  SCHOOL/UNIVERSITY
-  CRICKET STADIUM
-  F1 INTERNATIONAL CIRCUIT
-  GOLF COURSE
-  PARK
-  METRO STATION

Source: Google maps. Map not to scale. | \*Proposed to be developed







EASY CONNECTIVITY TO  
SECTOR 148-METRO STATION



CLOSE PROXIMITY TO THE PROPOSED\*  
INTERNATIONAL AIRPORT AT JEWAR

\*<https://www.livemint.com/news/india/jewar-airport-developer-to-be-finalised-by-november-1559281015688.html> | [https://gbnagar.nic.in/jewar\\_airport/](https://gbnagar.nic.in/jewar_airport/)

Stock image for representative purpose only.

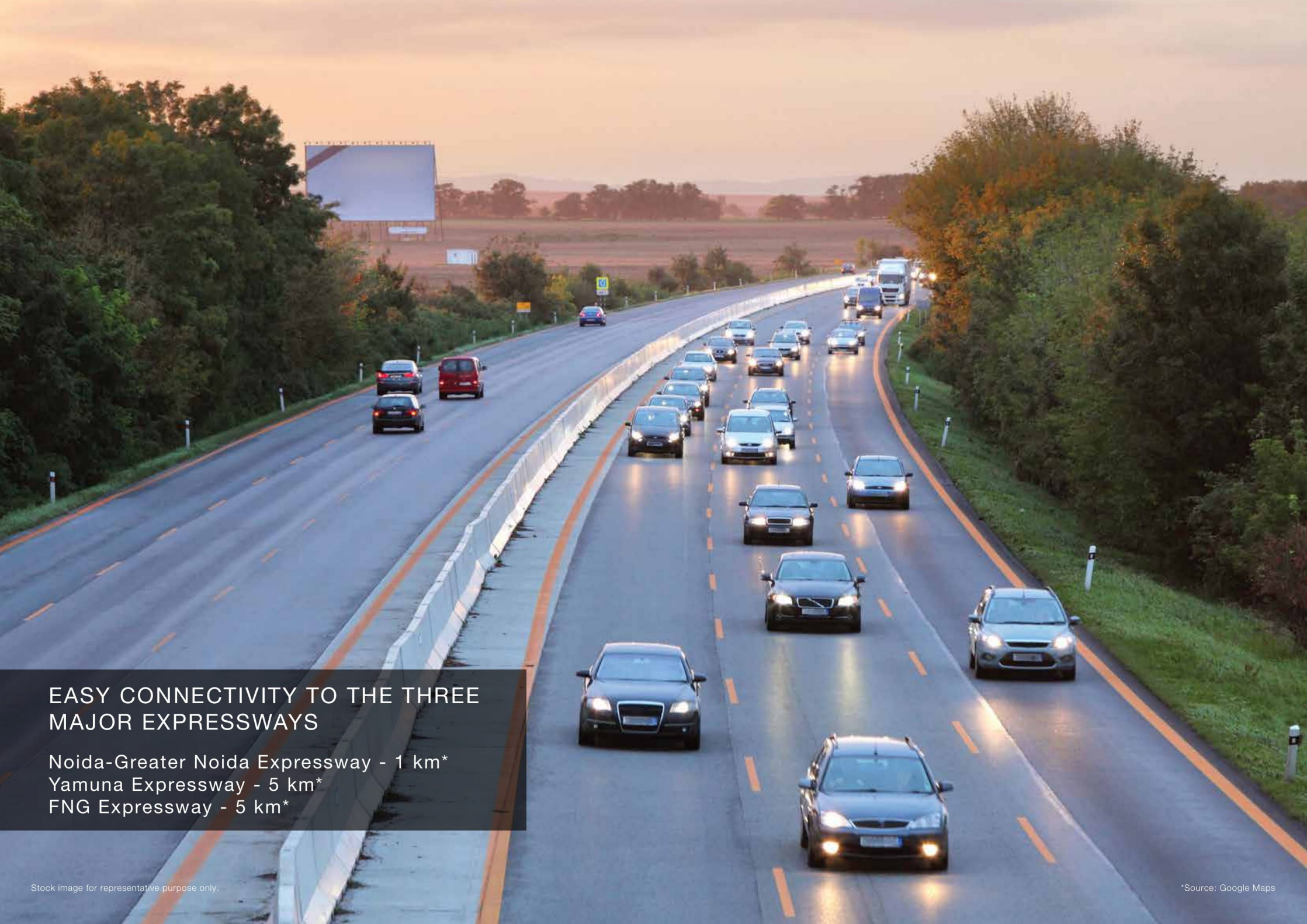

## EASY CONNECTIVITY TO THE THREE MAJOR EXPRESSWAYS

Noida-Greater Noida Expressway - 1 km\*  
Yamuna Expressway - 5 km\*  
FNG Expressway - 5 km\*

# SOCIAL INFRASTRUCTURE



Stock image for representative purpose only.

## WHEN THE BEST OF SOCIAL INFRASTRUCTURE SURROUNDS THE ADDRESS



### SCHOOLS

- Lotus Valley International School, Sector 126 - Noida
- DPS Gautam Budhha Nagar, Sector 132 - Noida
- Somerville International School, Sector 132 - Noida
- Shriram Millenium School, Sector 135 - Noida
- Genesis Global School, Sector 132, Noida



### COLLEGES & TECHNICAL INSTITUTES

- UP Technical University, Sector 62 - Noida
- Amity University, Sector 125 - Noida
- Galgotia University, Sector 17A - Greater Noida
- Sharda University, Knowledge Park III - Greater Noida
- Asian Academy of Film and Television, Sector 16A - Noida



### HOSPITALS & HEALTHCARE SETUPS

- Fortis, Sector 62 - Noida
- Apollo, Sector 26 - Noida
- Kailash Hospital, Sector 27 - Noida
- Max Hospital, Sector 19 - Noida
- Felix Hospital, Sector 137 - Noida



### CORPORATES

- Honda
- Moser Baer
- LG
- Wipro Technologies
- Ansal IT City And Parks Ltd.
- NIIT Technologies Ltd.

ADVANTAGE SECTOR 150

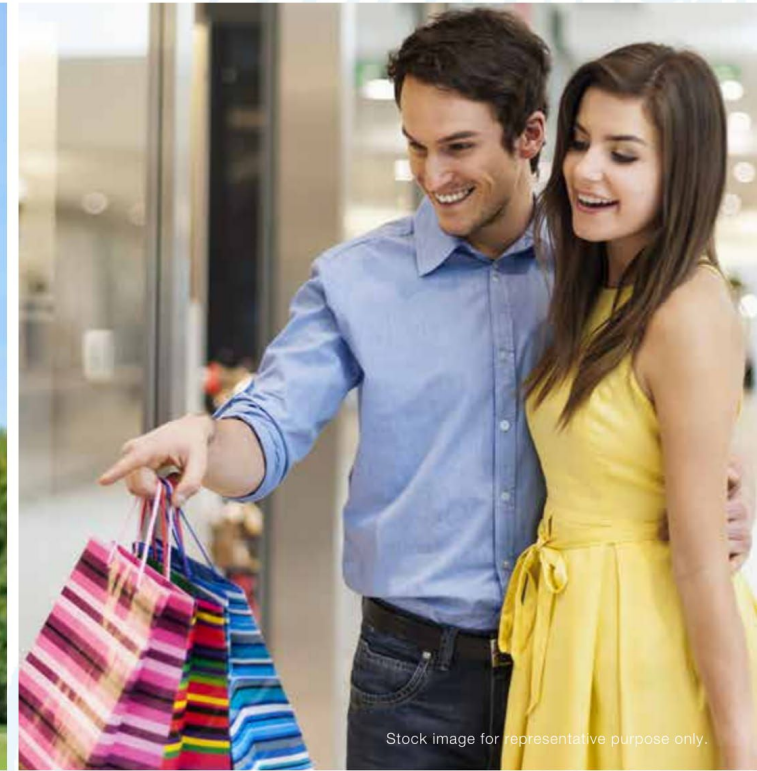

## LIVE A REFRESHED LIFE WITH 80% GREENERY

### NCR's 'greenest' Noida sector projects speed up

Purusharth Aradhak | TNN | Updated: Jun 15, 2015, 15:03 IST

✉ 🖨 A- A+



NOIDA: To speed up world class infrastructure in sector 150- which is considered as NCR's greenest sector, the Noida Authority top brass reviewed all projects.

On explaining the details Noida Authority on Sunday said that developed over 600 acre land, sector 150 will be the greenest sector of NCR. 80 percent of the sector will be green while with

42 acre, one of the biggest park in the country is also being developed in the same sector. Apart from that the authority has also planned to develop Sports city.

The Authority has also proposed Sports City project, which is being developed by Lotus Greens Developer. "The low-density Sports City, which is developed on 300 acres at a cost of over Rs 2,300 crore, will offer recreational as well as residential facilities. A separate provision for a permissible ground coverage and FAR (Floor Area Ratio) has been proposed as per the Building Regulations Act of Noida and its Master Plan 2031," a senior official, who attended the meeting said this Sports City will go a long way in establishing sporting infrastructure and become a sports destination. "In today's living standard, people have dropped physical activities. Space crunch is also another reason behind it. Some groups are running Rahgiri. Our idea is to offer sports more accessible to the population and to promote healthy living. The proposed sports city will provide a platform to both professionals as well as aspiring youngsters," said the official.

source: <https://timesofindia.indiatimes.com/good-governance/uttar-pradesh/NCRs-greenest-Noida-sector-projects-speed-up/articleshow/47675137.cms>

## BREAK-FREE FROM THE HASSLE OF OVERHEAD WIRES

### Noida's Sector 150 to be NCR's first overhead wires free zone

Purusharth Aradhak | TNN | Mar 5, 2015, 12:35 IST

✉ 🖨 A- A+

NEW DELHI: Sector 150 to be the first NCR Sector, which will be overhead wiring free, the Noida Authority officials said all kind of electric wires including power, internet, telephone etc. will be underwire thorough RCC ducts in Sector 150, which is also considered as "greenest sector of NCR".

To make the city overhead lines free, the Noida authority has initiated drive. All city lines to be replaced to underline ducts. The Authority officials said that in all new sectors, this technology to be used and from June 2015, work to be started in Sector 150, which is projected as ideal sector of NCR. After Sector 150, this technology will be followed in other new sectors along Noida-Greater Noida Expressway. Underwiring project is also executed in upscale Sector 18 market.

On explaining the details Vijay Kumar Yadav additional CEO Noida Authority said that the Authority is executing to underline all over headlines in Sector 18 and from June this year work will be started in Sector 150, which is developed by Noida Authority as an ideal sector of NCR.

"The Authority has plan to execute this process in Sector 150, which is developed state of art sector in the state and NCR. By June 2015, creation of cemented ducts to underline of overhead wiring work to be started. We will create RCC (Reinforced Cement Concrete) ducts along the roads so that all kind of wires either electric, telephonic, internet etc lay in the duct," Yadav said.

"In Sector 18, first phase of work has been completed while second phase to be started soon. We are expecting to complete it by the end of this year," the official said.

A senior official said that Sector 150 to first in the state to have established core IT

source: <https://timesofindia.indiatimes.com/city/noida/Noidas-Sector-150-to-be-NCRs-first-overhead-wires-free-zone/articleshow/46465491.cms>

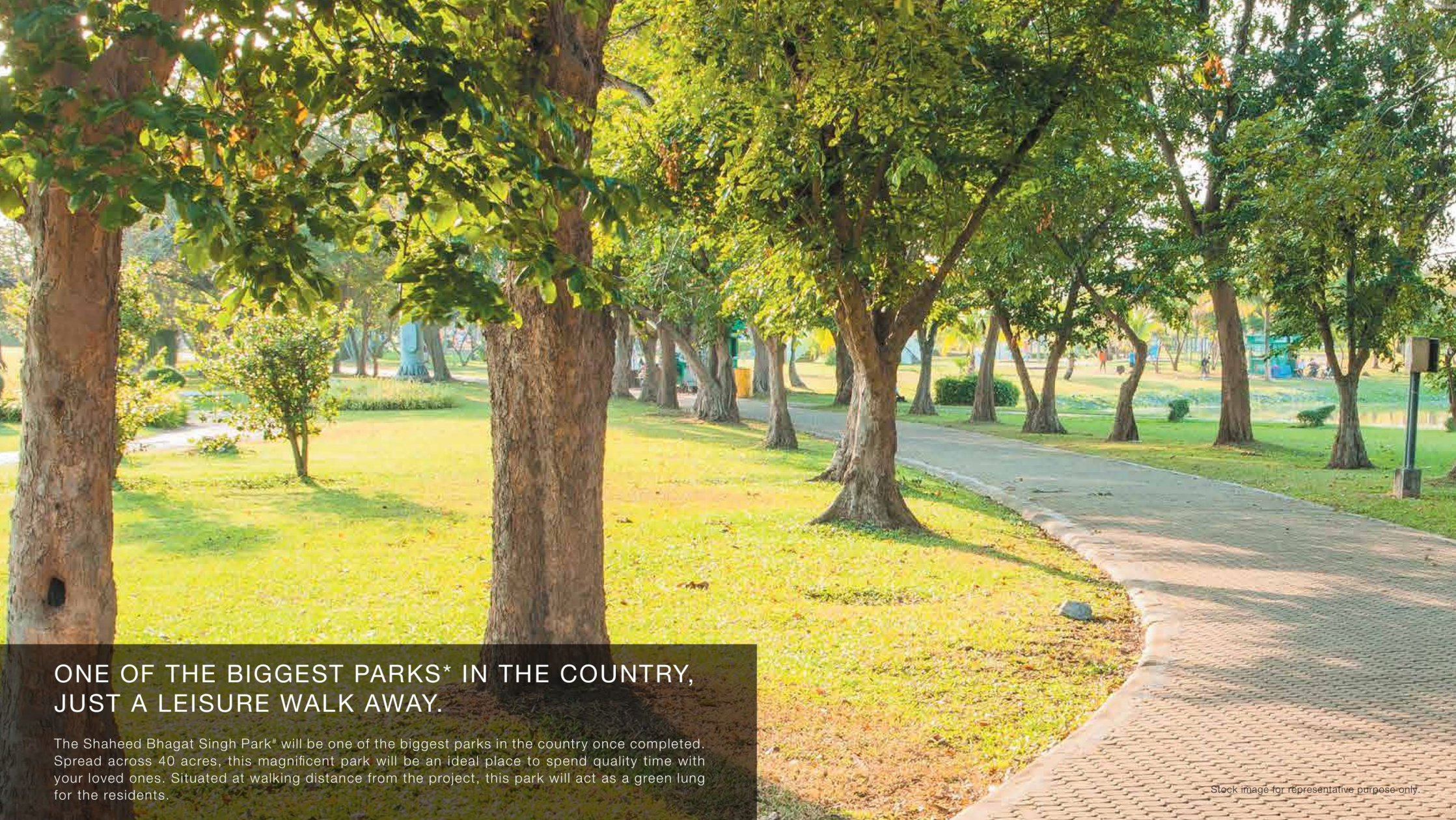

## ONE OF THE BIGGEST PARKS\* IN THE COUNTRY, JUST A LEISURE WALK AWAY.

The Shaheed Bhagat Singh Park# will be one of the biggest parks in the country once completed. Spread across 40 acres, this magnificent park will be an ideal place to spend quality time with your loved ones. Situated at walking distance from the project, this park will act as a green lung for the residents.

Stock image for representative purpose only.

### SHAHEED BHAGAT SINGH PARK FEATURES:

- Home to over 2000 large trees comprising of 58 native, naturalised and ornamental species
- Will incorporate about 45,000 shrubs to its green cover
- A unique ecosystem comprising of plants, small animals, insects, birds, butterflies etc.

\*<https://www.timesnownews.com/india/article/noida-park-martyrs-freedom-fighters-august-15-shaheed-bhagat-singh-park-sector-150-uttar-pradesh-pulwama-news/367861>

#Proposed. Not to be a part of Godrej Palm Retreat



Stock image for representative purpose only.

◀ MEGA SPORTS CITY – 9 HOLE GOLF COURSE & GOLF CLUB

INTERNATIONAL STANDARD CRICKET ACADEMY ▶



Stock image for representative purpose only.



Stock image for representative purpose only.

◀ EXPANSIVE RETAIL AND ENTERTAINMENT CENTRE

\*Proposed to be developed. Not a part of the project. It will be developed by a third party for which the developer is not responsible.





— PRESENTING —

# GODREJ PALM RETREAT

SECTOR 150, NOIDA

Godrej Properties brings you Enchanting Resort Residences, Godrej Palm Retreat. Built for a chosen few, living life to the fullest takes a whole new meaning here. With finest indulgences, it will be your preferred resort within the comfort of your home. Come, experience the never-ending vacation.



# EXOTIC RESORT STYLE LIVING

EXPERIENCE AN EXCLUSIVE  
TROPICAL LIFESTYLE



BESPOKE ARCHITECTURE WELCOMES YOU

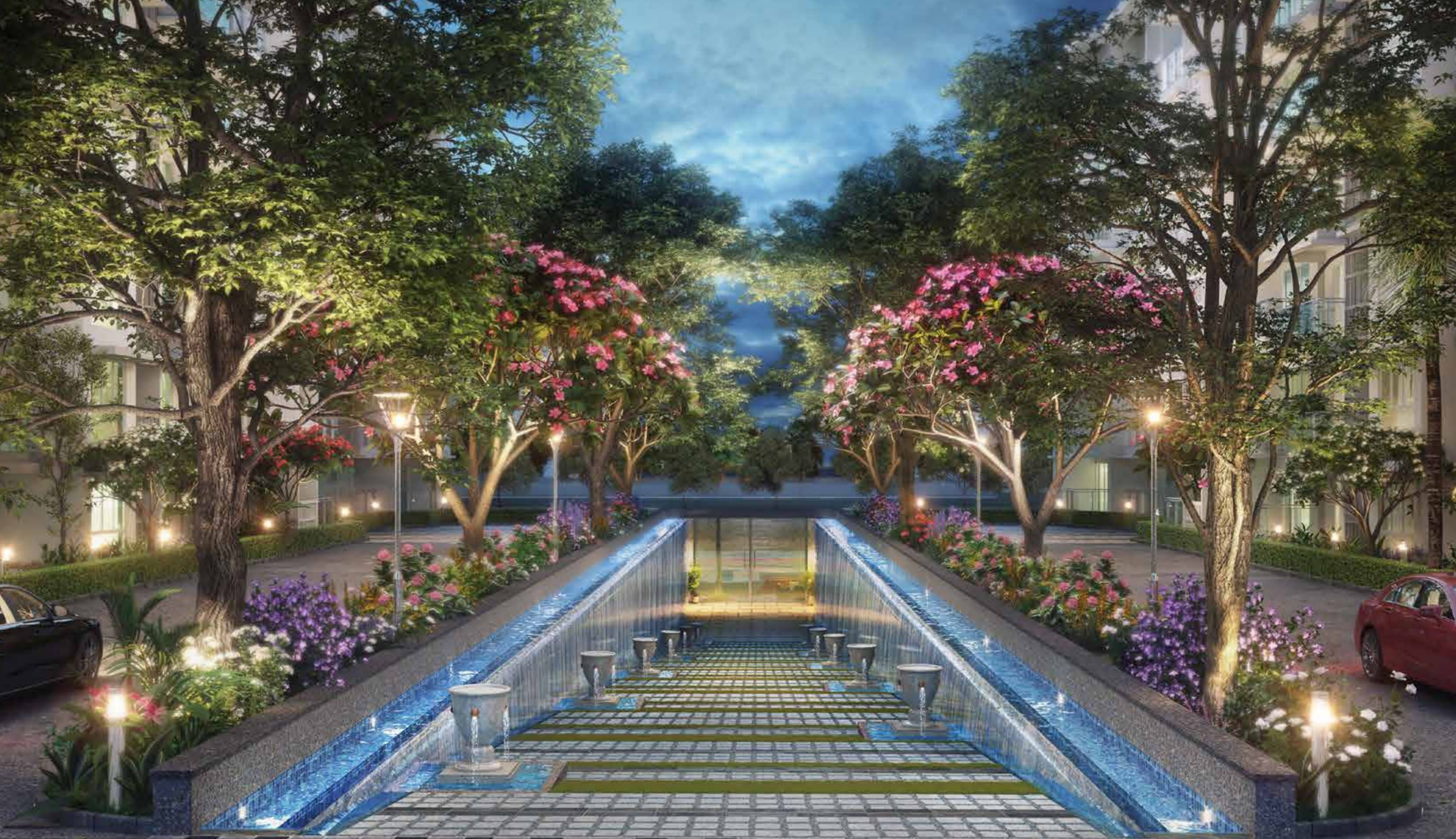

FEEL WELCOMED WITH LUXURIOUSLY DESIGNED  
CELEBRATION WATER WALL & GREEN WALKWAYS



**WATER WALLS LINING THE STUNNING TERRACED POOL**