

Office Spaces – Exclusivity Redefined!

- Lockable Office Space • Located at Spacious 90-Acre, Ready-to-Move-in Premium Golfcourse Township. • On 130-mtr wide road • Gym with globally renowned SFL Tie-up • Grand Sky-Bridge Restaurant • Bank Loan facility Available



Perspective View

SPECIFICATIONS:

1. The Company would provide common car parking space, parking charges would be payable to the assigned nominated agency as per parking agreement by the company.
2. Company will provide raw Office space without internal electrification, flooring, plaster & painting etc work.
3. Company will provide single electrical, drain & plumbing point inside office space. No internal work will be done inside any office space.
4. Company will develop and maintain external common area & external façade of the building.
5. Company will develop and maintain internal common area & office entry side, no individual will be permitted or authorized to change or make any kind of modification in common area & office entry side.
6. Company will reinstall signage for any office space in future also, through its nominated agency and the respective cost would be borne by the customer.
7. Company will provide common toilets for ladies & gents on each floor.



PARAMOUNT
GUIDED BY TOMORROW

PARAMOUNT GROUP OF COMPANIES:
Corporate Office: H-123, Sector-63, Noida-201305 (UP)

TOWNSHIPS • COMMERCIAL COMPLEXES • RESIDENTIAL COMPLEXES • VILLAS • IT PARKS • MALLS • HOTELS

Paramount Villas Pvt. Ltd. Allotment Letter- Ref. No.5672/SIDC/RMS/SRI-H-C(Ext.)Ph-1/plot no.BGH-A, Dated 18.10.2010-
Sanction Plan-Ref.No.2032/SIDC/RMS/SRI, Dated 13.06.2011, Sanction Plan-No.7096/SIDC/RMC/Building Plan/BGH-A/HC/SRI/Dated 04.01.2013.

Disclaimer: All specifications, design, layout, conditions are only indicative & some of these can be changed at the discretion of Builder/Architect/Authority, these are purely conceptual & constitute no legal offerings.

Member of
CREDAI

PARAMOUNT
GUIDED BY TOMORROW

PARAMOUNT
golfforesté
lockable office, opp. zeta sector, greater noida

Make the Smart Move
to the finest Office Address

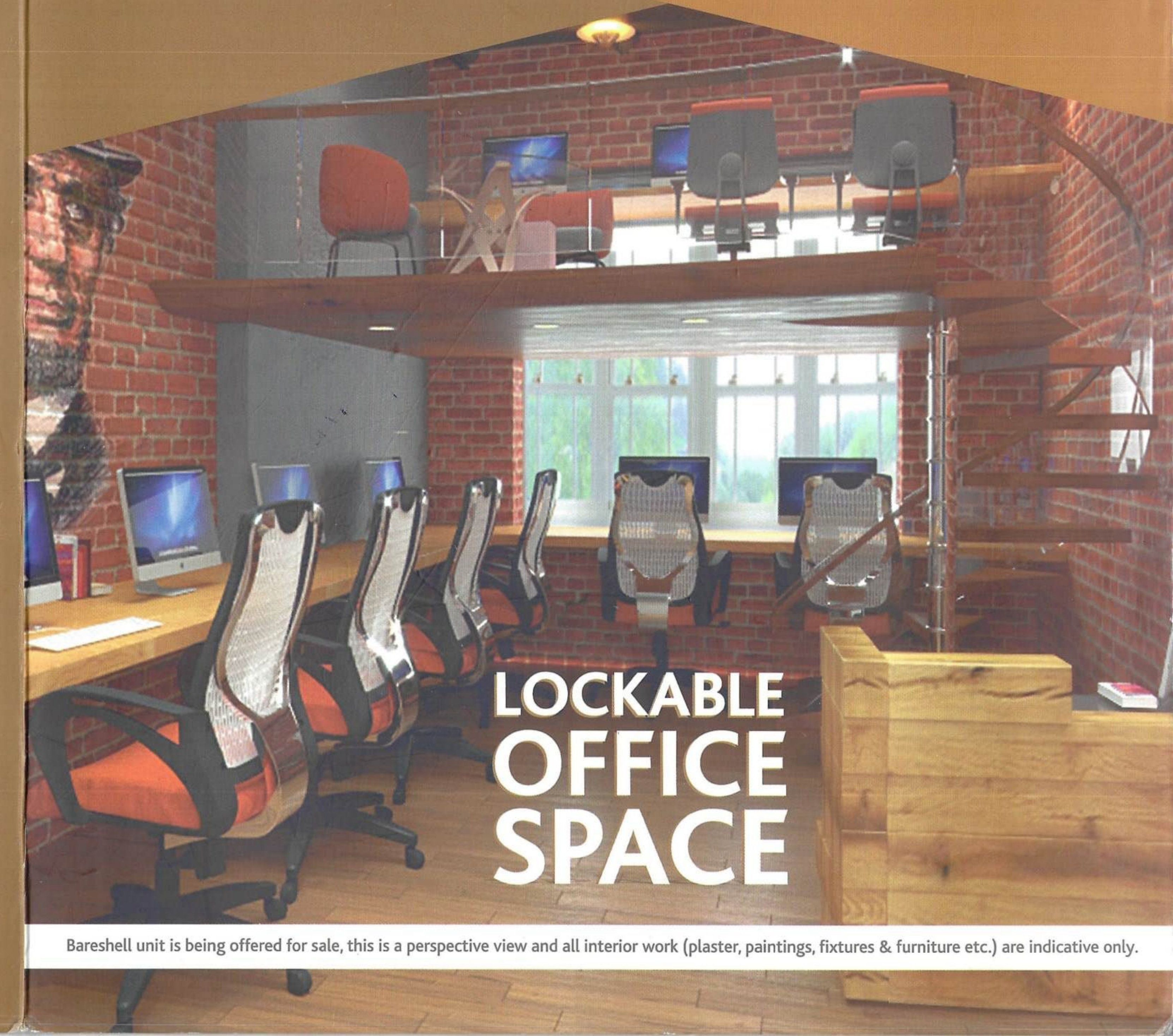

**LOCKABLE
OFFICE
SPACE**

Bareshell unit is being offered for sale, this is a perspective view and all interior work (plaster, paintings, fixtures & furniture etc.) are indicative only.

Floor Plans

Second Floor

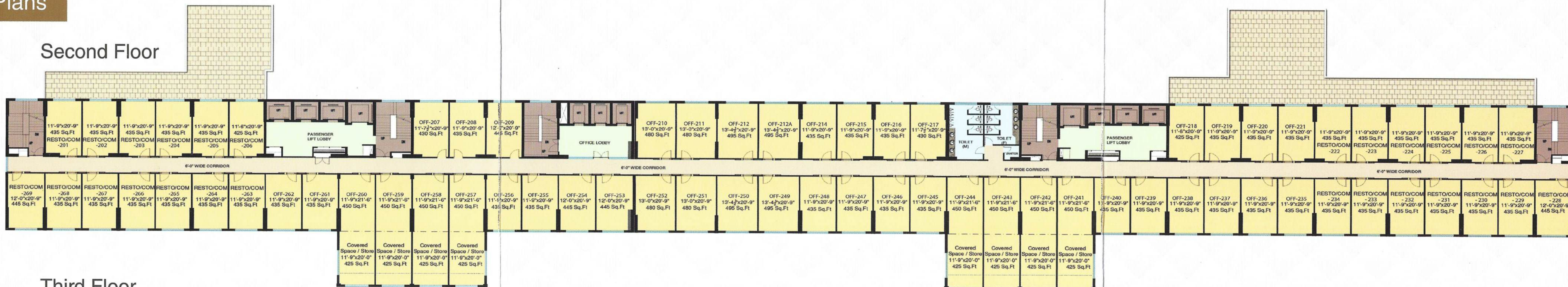

Third Floor

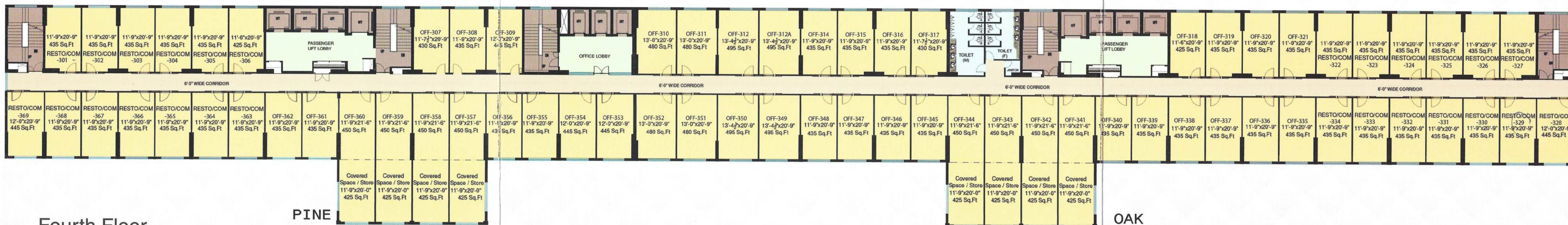

Fourth Floor

PINE

OAK

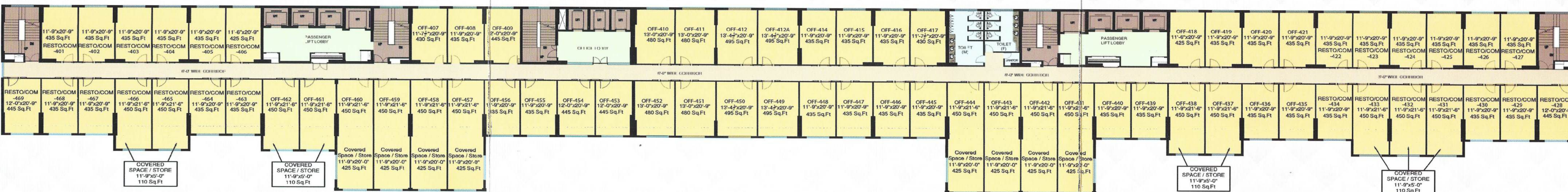

Disclaimer: All specifications, design, layout, conditions are only indicative & some of these can be changed at the discretion of Builder/Architect/Authority, these are purely conceptual & constitute no legal offerings.